

W&P Zement GmbH



W&P Zement GmbH



A Member of LOESCHE Family



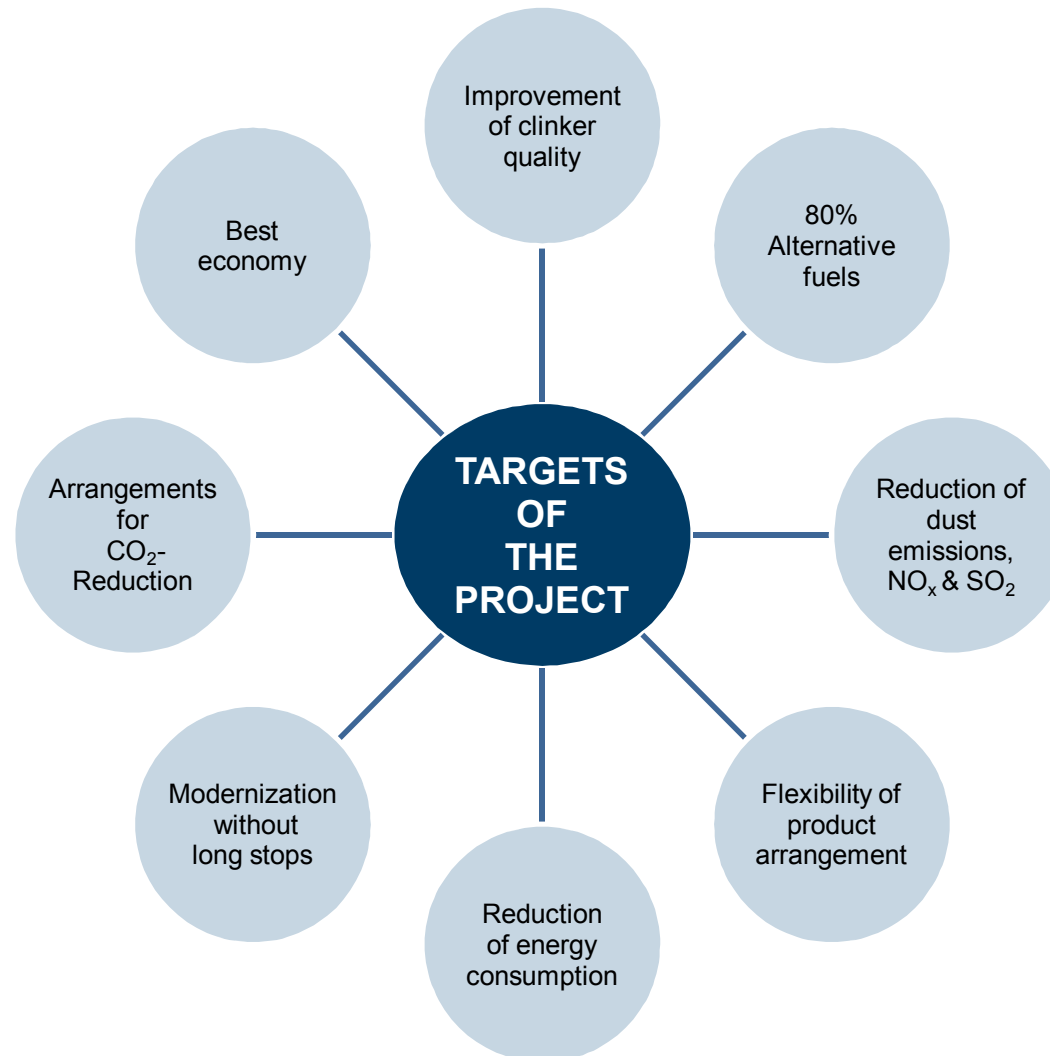

MAIN FEATURES

- Low Heat consumption
- Long Calciner Retention Time
- Usage of Low Grade Fuel
- Low Emission

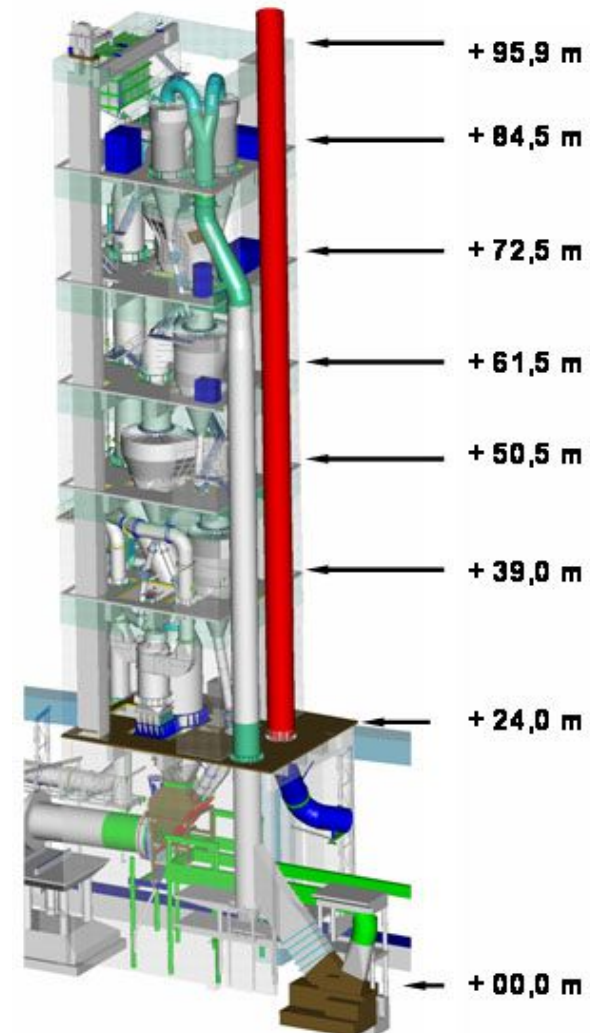

W&P Zement GmbH



	GUARANTEED	ACHIEVED
Capacity	> 1,600 t/d	1,820 t/d
Heat Consumption	< 3,230 kJ/kg	< 3,120 kJ/kg
Pressure Drop	< 71 mbar	< 55 mbar
NO_x	< 500 mg/nm ³	< 430 mg/nm ³
SO₂	< 50 mg/nm ³	< 50 mg/nm ³

ALTERNATIVE FUELS

- Preparation
- Storage
- Feeding
- Burning

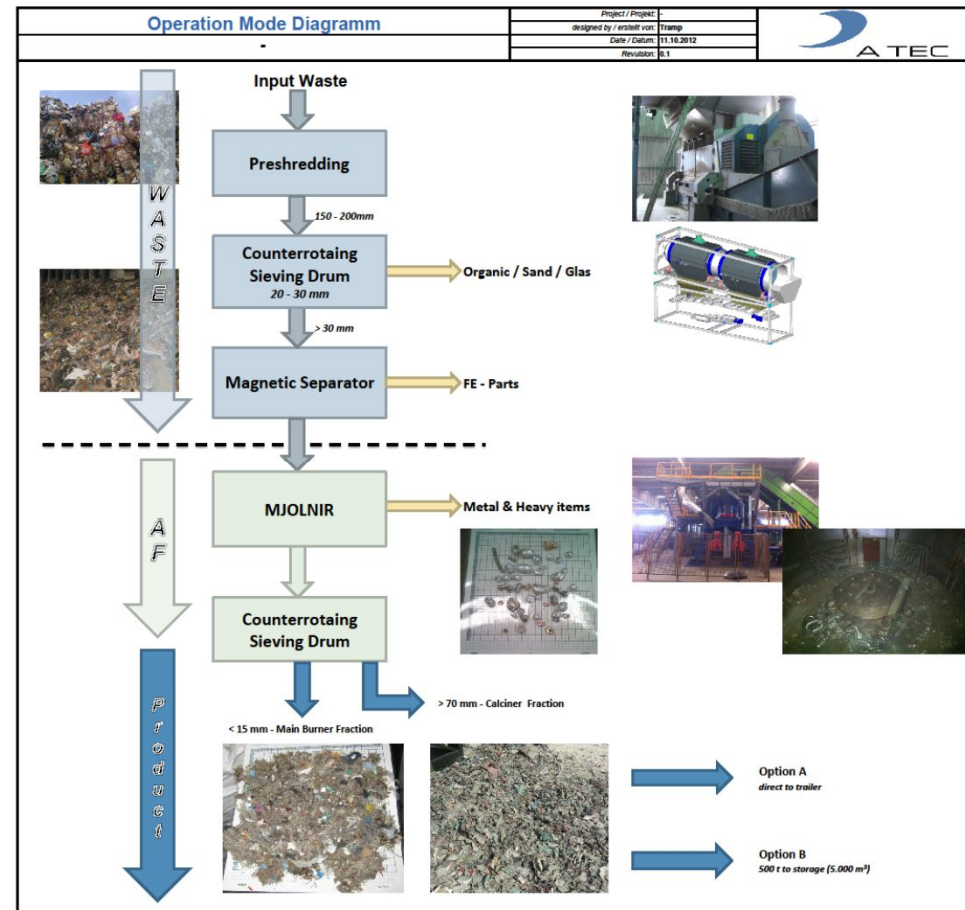

Locations



A Member of LOESCHE Family

Engineering & Technical Center

A TEC Production & Services GmbH
Finkensteinerstraße 9 (Gewerbepark Zufahrt A)
9585 Gödersdorf, AUSTRIA
Tel.: 0043 4257 3600
Fax: 0043 4257 3600 101
E-Mail: office@atec-ltd.com

A TEC GRECO Brasilien Operation

A TEC GRECO Projetos e Equipamentos Ltda.
Rua Dr. Olavo Egídio , 287, 7 Andar, Sala 71
Santana, 02037-000 Sao Paulo, BRAZIL
Tel.: 0055 11 3500 2777
Fax: 0055 11 3500 2778
E-Mail: info.br@atec-greco.com

Production, Maintenance & Installation

A TEC Plant Construction GmbH
Steirerstraße 17
9372 Eberstein, AUSTRIA
Tel.: 0043 4264 8187
Fax: 0043 4264 8187 301
E-Mail: production@atec-ltd.com

Office China

A TEC Technology Services (Beijing) Co.
Room 1122, Hongtown Business Center,
Dong Zhi Men Wai Xie Street,
Dongcheng District, 100027 Beijing, PR CHINA
Tel.: 0086 10 5900 0860
Fax.: 0086 10 8950 8100
E-Mail: china@atec-asia.com

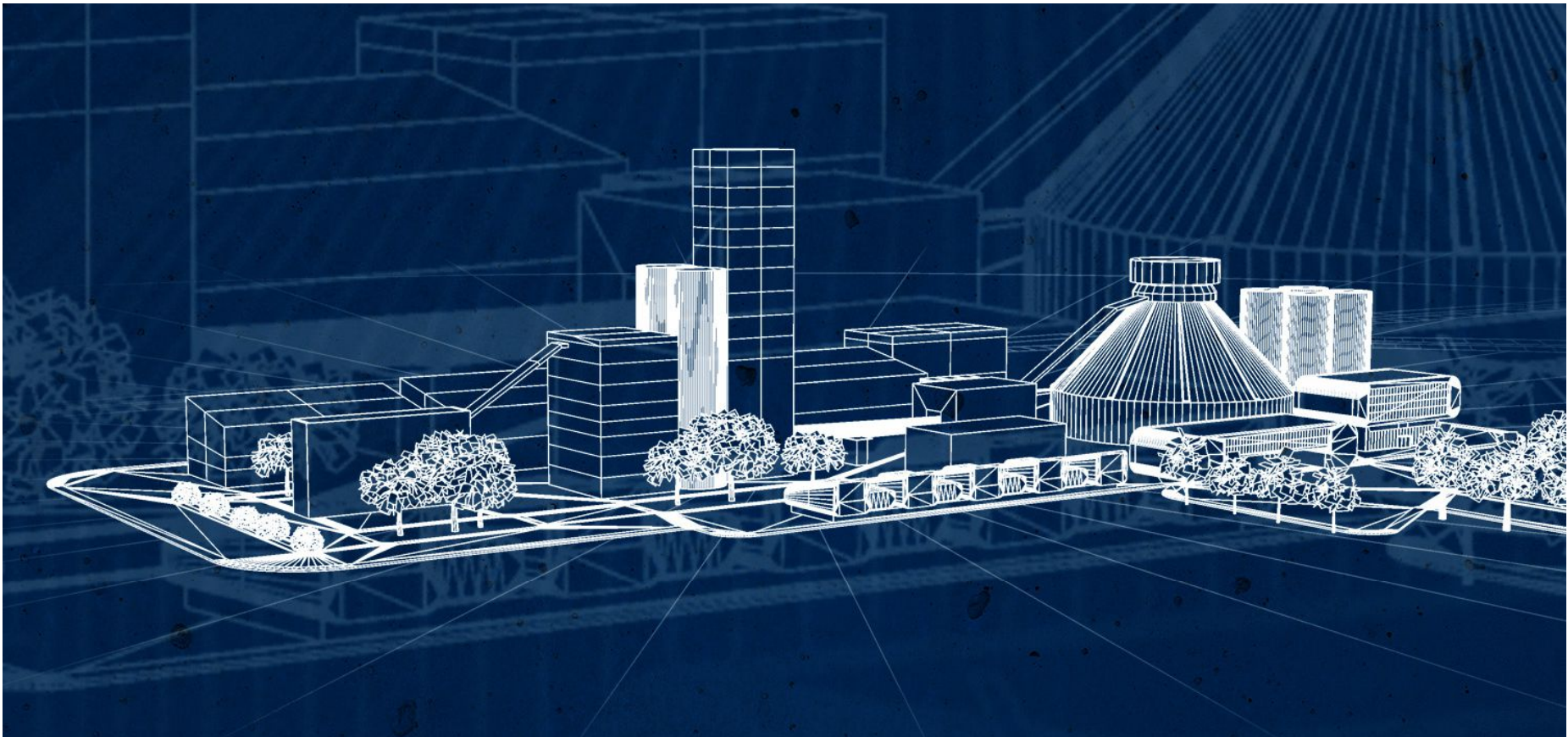

Contact Us

www.atec-ltd.com



A Member of LOESCHE Family